

Underhook/In-Line Strain Gauge Lift Link with Remote Telemetry Linked Display

LIFT LINK SYSTEM

ET Series

Telemetry Linked
Version



- Ranges 1 tonne to 100 tonne
- Designed for use with standard Lifting Shackles
- Sealed to IP65
- Robust Construction
- Accuracy 0.25% typical
- Range up to 200 metres
- Auto Power Down
- Up to 255 links can be used in a single installation
- 3 YEAR WARRANTY

Options Available

Rechargeable batteries and charger
(for handheld receiver only)

Bow or D type Shackles

Wire Linked Version

Higher Capacity Versions

DESCRIPTION

The ET series of Lift Link Load Cells has been specifically developed for the measurement of cable tension and under hook crane/lifting gear weighing.

The accuracy achieved by the ET series is unrivalled in its price range and combines high quality with excellent value for money. The weight and overall height of the ET series is much lower than that offered by other manufacturers, therefore reducing the headroom required for the installed system.

The ET is environmentally sealed to IP65 to give excellent waterproofing properties for use outside in arduous conditions. The instrument is housed in a robust ABS enclosure with leather protective case. Operating at 433.92MHz, the operator has only 3 front panel tactile switches ON/OFF, HOLD and TARE. The 8 character alpha numeric display is 7mm high, and has 5 digit resolution. Both link and instrument include automatic power down, when not in use, to conserve battery life and are addressable to enable up to 255 units to be used on one installation. Each ET Telemetry Lift Link system is supplied in a rugged carrying case with calibration certificate and full supporting documentation.

It comes with Applied Measurements standard 3 year warranty.

Transducer Specialists...

APPLIED MEASUREMENTS LIMITED

3 MERCURY HOUSE - CALLEVA PARK - ALDERMASTON - BERKSHIRE - RG7 8PN - UK

Tel: (+44) 0118 981 7339 Fax: (+44) 0118 981 9121 email: info@appmeas.co.uk Internet: www.appmeas.co.uk



SPECIFICATION

CHARACTERISTICS	ET LIFT LINK
Ranges (F.R.):	1, 2, 5, 12, 25, 35, 50, 100 tonne
Accuracy:	< 0.25% FR typical.
Temperature Range:	-10 to +80 °C
Safe Overload:	2 x F.R.
Ultimate Overload:	5 x F.R.
Construction:	Anodised Aluminium Alloy
Environmental Protection:	IP65
Transmission Range:	200 metres
Battery Life:	200 hrs continuous
Battery:	2 x 3.6V lithium
Auto Power Down:	9 hrs from power on

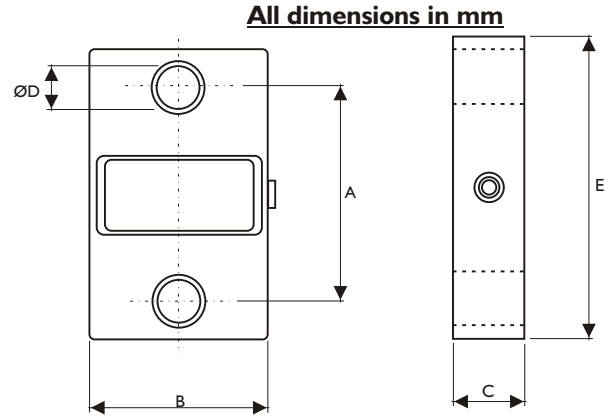

RANGE	A	B	C	ØD	E	WEIGHT
1, 2, 5 t	108	105	40	Ø30	164	1.4kg
12 t	120	105	40	Ø38	210	1.9kg
25 t	131	125	55	Ø53	255	4kg
35 t	147	135	55	Ø60	305	5kg
50 t	170	150	75	Ø73	345	9kg
100t	228	220	123	Ø100	455	27kg

CHARACTERISTICS	HAND HELD DISPLAY
Display:	8 Character Alpha Numeric 7mm high LCD
Keyboard:	3 key tactile ON/OFF, HOLD, TARE
Battery:	9V PP3 lithium (1.2Ah)
Battery Life:	10 hours minimum
Frequency:	433.92MHz UK and Europe
Auto Power Down:	After 5 minutes in "Waiting" mode
Temperature Range:	-10 to +55 °C
Environmental Protection:	IP65
Weight:	420gms with leather case

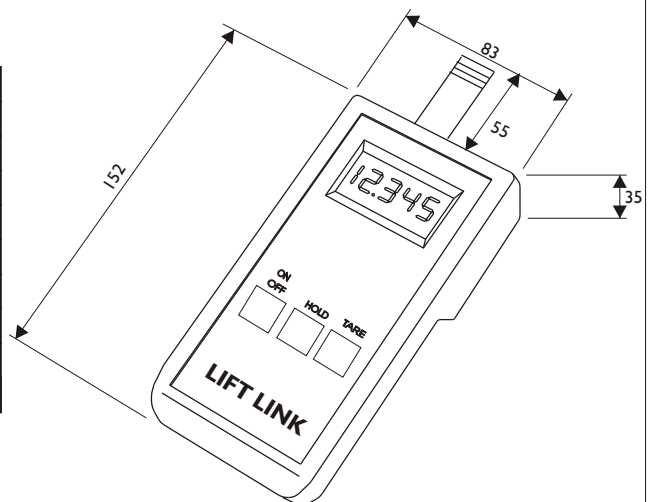

All dimensions in mm

